



Bay Architects

18201 Gulf Freeway
Webster, Texas 77598
Tel 281.286.6605
Fax 281.286.9606

ADDENDUM NO. 05

13 August 2010

Project: **NEW TRANSPORTATION, MAINTENANCE and AGRICULTURAL BUILDINGS**
Channelview Independent School District

Issued by: **Bay Architects, Inc.**
18201 Gulf Freeway
Webster, TX 77598
281-286-6605

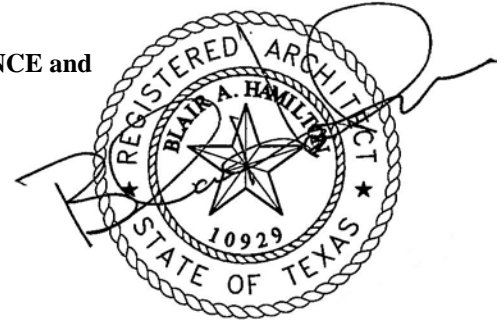

08/13/10

Bay Project No.: **0937**

Prepared for: **Prospective Proposers**

PART A: NOTICE TO PROPOSERS:

1. Receipt of this Addendum shall be acknowledged on the Proposal Form. Failure to do so may subject Proposers to disqualification. Each proposer shall make necessary adjustments and submit his proposal with full knowledge of all modifications, clarification, and supplemental data included therein.
2. This Addendum forms part of the Contract Documents and shall be incorporated integrally therewith. Where provisions of the following supplemental data differ from those of previously issued documents, this Addendum shall govern.
3. The following Contract Documents have been issued to date delineating the Work (Project).

Contract Documents	8 July 2010
Addendum No. 01 – ARCH	4 August 2010
Addendum No. 02 – MEP	4 August 2010
Addendum No. 03 – CIVIL	5 August 2010
Addendum No. 04 – CIVIL	11 August 2010

4. This Addendum consists of: four (4) 8-1/2x11 written pages; four (4) 8-1/2x11 pages Sections 10100 and 11132; and one (1) 8-1/2x11 sketch **ADD-05-01**; as prepared by Bay Architects, Inc. Total pages included in this Addendum: 9 pages.

PART B: CHANGES TO PRIOR ADDENDUM

“Any changes to prior issued addendum materials are listed here.”

5. None

PART C: CHANGES TO THE PROJECT MANUAL

6. Table of Contents: Section III Specifications, page 3, Division 10, add the following:

- 10100 Miscellaneous Specialties.....1-2
7. Table of Contents: Section III Specifications, page 3, Division 11, add the following:
11132 Projection Screens.....1-2
8. Section 04200 Unit Masonry, page 3, 2.2-C-03: delete and replace with the following:
03 Comply with ASTM C90 (class D-2 block at 2-hour rated walls, class D-3 block at 3-hour rated walls)
a. Grade: N, highest standard
b. Type: I, Moisture -controlled unit
c. Aggregate: Lightweight
9. Section 05500 Miscellaneous Metals, page 3, 2.2: add the following:
J. Trench Covers and Frames:
01 Design is based on products manufactured by Grating Pacific; or equal by listed manufacturer.
02 Acceptable Manufacturers:
a. Grating Pacific (basis of design)
b. Neenah Foundry
c. Balco
d. Architectural Art Manufacturing
e. MM Systems Corp.
03 Trench Frame: 1-1/4" x 1-1/4" continuous angle frame with welded 3/8" x 3" embedment nelson studs at 24" O.C. max; hot-dip galvanized finish.
04 Grating: Grating Pacific TSA-12-EZ 1" deep standard duty trench grating; hot-dip galvanized finish. Provide in nominal 48" sections.
05 Provide mechanically fastened hold-down clips to securely attach grate covers to angle frame..
10. Section 08335 Overhead Coiling Doors, page 2, 2.1: add the following
E. Raynor
11. Section 09770 Concrete Sealer, page 1, Part 2 – Materials, add the following:
2.2 MATERIALS AND MANUFACTURERS – TRAFFIC AREAS
A. Design of concrete floor sealer for vehicular traffic areas of the buildings is based on Euclid Chemical Company "Euco Diamond Hard" liquid densifier and sealer.
B. Properties
01 Clear, water based, penetrating blend of silicate polymers
02 Ultraviolet and chemical resistant
03 Abrasion / Wear Resistance: meet or exceed ASTM C 779
04 Coefficient of Friction: meet or exceed ASTM F 1679
C. Manufacturers:
01 L.M. Scofield
02 Prosoco
03 ZEP Manufacturing

- D. Provide at the following locations:
 - 01 Maintenance Building Warehouse 405
 - 02 Maintenance Shops Building Grounds 505A, Mechanics 505B, HVAC 506A, Plumbing carpentry Bldg. Maintenance 507A.
- 12. Section 10100 Miscellaneous Specialties; add entire section (attached). (2 pages)
- 13. Section 10520 Fire Extinguishers and Cabinets, page 1, 2.1-A: Delete and replace with the following:
 - A. Fire Extinguisher Cabinets (designated 'FEC' on the Drawings):
 - 01 Design is based on JL Industries
 - a. Non-Fire-Rated Model: CS20 series
 - b. Fire-Rated Model: CSFX20 series 1 and 2 hour rating as appropriate for rated partition being installed in.
 - 02 Nominal 27" x 12" x 7-3/4" inside box dimension (non-rated); 29" x 14" x 8-3/4" inside box dimensions (rated).
 - 03 Semi-recessed type rolled edge return trim.
 - 04 Door: tempered glass with continuous hinge and flush cup recessed handle, complying with requirements of A.D.A. and Texas Accessibility Standards.
 - 05 Silk-screened lettering "Fire Extinguisher" – red letters.
 - 06 Finish: powder coated finish – white.
 - 07 All fire extinguisher cabinets shall be furnished with 10 lb. fire extinguisher.
 - 08 Provide brackets within all cabinets.
- 14. Section 11132 Projection Screens; add entire section (attached). (2 pages)
- 15. Section 13120 Pre-Engineered Steel Buildings, page 2, 2.1-A: add the following:
 - 14 Alliance Steel Buildings

PART D: CHANGES TO THE DRAWINGS

- 16. Sheet C1.06 Architectural Site Plan Agricultural Facility: 4/C1.06, revise drawing scale to 1" = 30'-0".
- 17. Sheet A2.01 Transportation Floor Plan and Schedules: Door Schedule - Area "A" First Floor, revise the following door elevations to type 'B' 102-1, 103-1, 104-1, 105-1, and 107-1.
- 18. Sheet A2.03 Maintenance Area "B" Floor Plan: 4/A2.03, Office 310B, delete window 310B-B.
- 19. Sheet A2.03 Maintenance Area "B" Floor Plan: 4/A2.03, Warehouse 405, revise West Wall CMU Partition F54 to F60, 3HR Rated Assembly.
- 20. Sheet A2.04 Maintenance Area "B" Schedules: Window Schedule - delete window 310-B-B.
- 21. Sheet A2.04 Maintenance Area "B" Schedules: Door Schedule - Area "B" First Floor, revise the following door elevations to type 'B' : 102-1, 103-1, 104-1, 105-1, 106-1, 107-1, 108-1, 109-1, 110-1, 200-2, 202-1, 201-1, 202-1, 301-1, 302-1, 303-1, 304-1, 305-1, 305-2, 306-1, 307-1, 308-1, 309-1, 310-1, 401-1, and 401-2.

22. Sheet A2.04 Maintenance Area “B” Schedules: Door Schedule - Area “B” First Floor, revise the Fire Rating Label to 3hr for the following doors: 311-1, 315-1, 400-1, 400-2, 403-2, and 407-1.
23. Sheet A2.04 Maintenance Area “B” Schedules: Door Schedule - Area “B” First Floor, revise door; 404-3 to Pair 4’-0” x 9’-0” H.M. doors.
24. Sheet A4.01 – Transportation Roof Plan & Details, details 2 and 4: delete “3/4” plywood” and “ice & water shield” notes. Clarify that no plywood or ice & water shield are components of the pre-engineered metal roofing.
25. Sheet A6.00 Partition Types: add partition type F60- 3 HR wall as shown on attached drawing **ADD-05-01**.
26. Sheet A7.01 Exterior Elevations: Detail 1/A7.01, 2/A7.01, 3/A7.01, 4/A7.01, 5/A7.01, revise eave height to 12’-7” at Transportation Building.

PART E: RE-ISSUED SHEETS

27. None

END OF ADDENDUM

SECTION 10100

MISCELLANEOUS SPECIALTIES

(THIS SECTION ISSUED IN ITS ENTIRETY IN ADDENDUM NO. 5)

PART 1 - GENERAL

1.1 RELATED DOCUMENTS

- A. Drawings and general provisions of the Contract, including General, Supplementary and Special Conditions and other Division 1 Specification Sections, apply to this Section.
- B. Refer to Instructions to Proposers for substitutions of materials and products.
- C. Addenda issued during the proposal period that affect this section of the specifications.
- D. Fire suppression range hood.

1.2 SUBMITTALS

- A. Manufacturer's specifications and other data for all products propped to be furnished as needed to demonstrate compliance with specified requirements
- B. Shop Drawings: complete detailed shop drawings indicating fabrication and installation details and connection with all interfacing work.
- C. Manufacturer's complete installation instructions, including wiring diagrams.

1.3 QUALITY ASSURANCE

- A. Manufacturers Qualifications: Materials and systems shall be manufactured by a company continuously and regularly employed in the manufacture of specified materials for a period of at least five (5) consecutive years.

PART 2 - PRODUCTS

2.1 FIRE SUPPRESSION RANGE HOODS

- A. Design is based on Cook Safe series CV Automatic Fire Suppression Range Hood; model CV-WM-E; or equal product by approved manufacturer.
 - 01 Unit to be ETL listed to UL300A and UL507 test standards.
 - 02 Fan motor to be permanently lubricated and meet UL507 standards.
- B. Unit shall be under-cabinet mounted.
- C. Unit shall be minimum 20 gage #4 polished 304 stainless steel..
- D. Hood shall be top discharge using a 7" diameter duct.
- E. Centrifugal fan at minimum 250 CFM.
- F. Fire suppression activation shall be by two independent methods: automatic fusible link, and remote pull station adjacent to the range / oven. Coordinate with Architect and other trades for exact location.
- G. Extinguishing agent shall be pressurized cylinder; potassium carbonate.
- H. Activation of unit shall cut off electrical power to the range / oven. Coordinate with other trades as required for correct interface.

PART 3 - EXECUTION

3.1 INSTALLATION – FIRE SUPPRESSION RANGE HOOD

- A. Coordinate installation with other trades to provide treated wood blocking as required for secure mounting.
- B. Install in accordance with manufacturer's printed instructions as accepted in submittal phase.
- C. Coordinate with other trades as required for proper interface with range / oven, electrical and fire alarm system.
- D. Upon completion and as required by governing authority, fully test system to confirm and demonstrate proper installation and operation.
- E. Upon Owner's acceptance of the building, each unit shall have a fully charged canister.

END OF SECTION

SECTION 11132

PROJECTION SCREENS

(THIS SECTION ISSUED IN ITS ENTIRETY IN ADDENDUM NO. 5)

PART 1 - GENERAL

1.1 RELATED DOCUMENTS

- A. Drawings and general provisions of the Contract, including General, Supplementary and Special Conditions and other Division 1 Specification Sections, apply to this Section.
- B. Refer to Instructions to Proposers for substitutions of materials and products.
- C. Addenda issued during the proposal period that affect this section of the specifications.

1.2 SUBMITTALS

- A. Manufacturer's specifications and other data needed to prove compliance with specified requirements.
- B. Complete shop drawings including screen composition and mounting details.
- C. Manufacturer's installation instructions.
- D. Electrical Requirements

1.3 WARRANTY

- A. Warrant product for one year from failure to operate per specifications and from manufacturing defects.

PART 2 - PRODUCTS

2.1 MANUFACTURERS

- A. Da-Lite (basis of design)
- B. Draper

2.2 MATERIALS

- A. Electric Projection Screens:
 - 01 Type: Da-Lite "Senior Electrol electrically operated projection screen; or equivalent by Draper.
 - 02 Provide with Video Spectra 1.5 viewing surface
 - 03 Viewing Area Size (nominal): as indicated at locations below. Projection viewing surface with black extension marking to lower bottom of screen to 24" above finish floor.
 - 04 Pre-wired 115 volt AC, 60 Hz, 2.5 Amp, three wire quick reversal motor with automatic thermal overload cutout and integral interlocking gears.
 - 05 Operation: Wall mounted control box with spring loaded key and cover-plate upper and lower limit switches with positive stop action UL rated.
- B. Electric Projection Screen Location:
 - 01 Maintenance Bldg, Training / Breakroom 401: Viewing size 8'-0" x 12'-0".
 - 02 Transportation Bldg Meeting Room 111: Viewing size 8'-0" x 12'-0".
- C. Wall Mounted Manual Projection Screens:
 - 01 Type: Da-Lite Model "B" wall mounted, manually operated projection screen; or equivalent by Draper
 - 02 Da-Mat viewing surface

- 03 Size: 6'-0"H x 8'-0"W (nominal) projection viewing surface. All screens shall be provide with black extension marking to lower bottom of screen to 36" above finish floor.
 - 04 Mounting Height: 96" above finish floor
 - 05 Provide 6" extension brackets for wall mounting.
 - 06 Provide pull down extension rods as required.
- D. Wall Mounted Manual Projection Screen Locations:
- 01 Transportation Bldg Conference Room 105
 - 02 Maintenance Bldg Conference Room 305
- E All projection screen housings and brackets shall be a factory applied powder coat paint finish; color shall be white.

PART 3 - EXECUTION

3.1 INSTALLATION

- A. Install in accordance with manufacturer's printed instructions.
- B. Mount electric projection screen at Cafetorium D132 in ceiling recess.
- C. Coordinate with electrician for proper installation of electrical and wall mounted electric operator(s) where specified
- D. Coordinate with other trades as required to mount projection screens centered about ceiling mounted projectors. Refer to A10.XX series Drawings for projector locations.
- E. Adjust for proper operation.

END OF SECTION

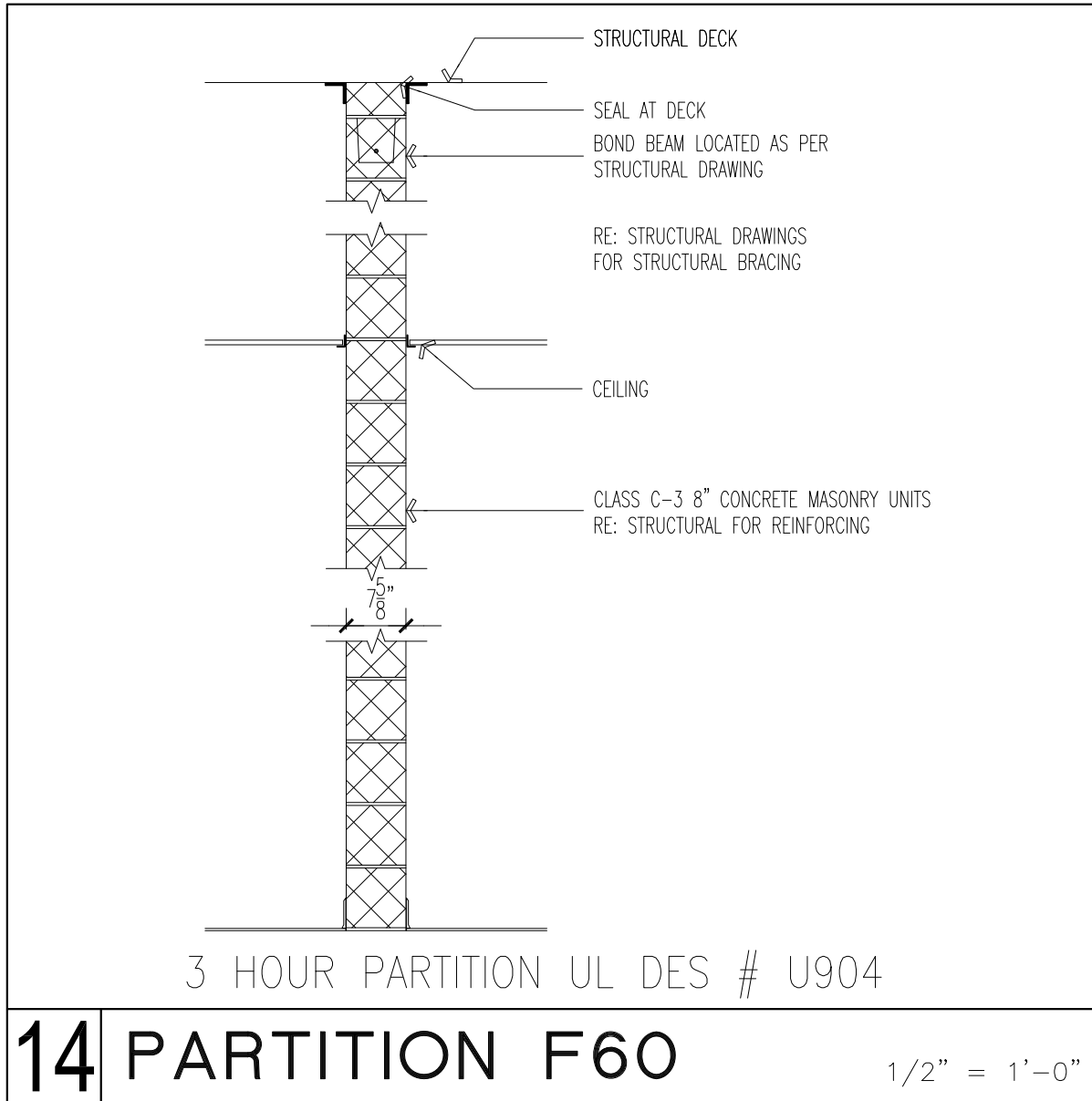

PARTITION TYPE



BAY ARCHITECTS
18201 GULF FREEWAY
P.O. BOX 891209
HOUSTON, TEXAS 77289
281.286.6605

NEW MAINTENANCE, TRANSPORTATION, AND AG FACILITY
CHANNELVIEW I.S.D.

ADD-05-01
0937
Not To Scale
08/13/2010
A2.01